



PISTON PRESSURE SENSORS

FOR PRESSURE SWITCH



HAUPTMERKMALE

- ◆ Fühler: Kolben
- ◆ Messbereich: 1...10 bis 60...600 bar
- ◆ Anwendung: Druckschalter

CARACTÈRES DISTINCTIFS

- ◆ Capteur: piston
- ◆ Plage de mesure: 1...10 à 60...600 bar
- ◆ Application: Interrupteur à pression

MAIN CHARACTERISTICS

- ◆ Sensor: piston
- ◆ Measuring range: 1...10 to 60...600 bar
- ◆ Application: Pressure switch

**FÜR DRUCKSCHALTER / POUR INTERRUPTEUR À PRESSION / FOR PRESSURE SWITCH:
944, 945, 946, 947, 948, 953**



Bereich
Plage
Range [bar]

Überdruck
Surpression
Overpressure [bar]

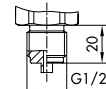
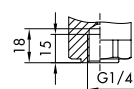

G1/4"

G1/2"

innen
femelle
female

aussen
mâle
male

78	1.0... 10.0	100	A		700	702	
				B	701	703	
81	4.0... 40.0	200	A		704	706	
				B	705	707	
82	6.0... 60.0	200	A		708	710	
83	10.0... 100.0	200	B		709	711	
84	16.0... 160.0	400	A		712	714	
85	25.0... 250.0	400	B		713	715	
86	40.0... 400.0	1000	A		722	724	
87	60.0... 600.0	1000	B		723	725	

A Kolben: 1.4435
O-Ring: NBR
Servo-/Stepseal: PTFE

Piston: 1.4435
O-Ring: NBR
Servo-/Stepseal: PTFE

Piston: 1.4435
O-Ring: NBR
Servo-/Stepseal: PTFE

B Kolben: 1.4435
O-Ring: FKM
Servo-/Stepseal: PTFE

Piston: 1.4435
O-Ring: FKM
Servo-/Stepseal: PTFE

Piston: 1.4435
O-Ring: FKM
Servo-/Stepseal: PTFE

MASSBILDER / COTES D'ENCOMBREMENT / DIMENSIONS

700, 701

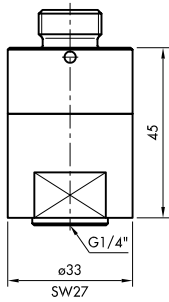

702, 703

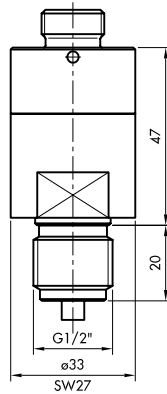

704, 705, 708, 709, 712,
713, 722, 723

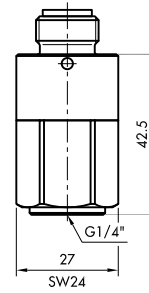

706, 707, 710, 711, 714,
715, 724, 725

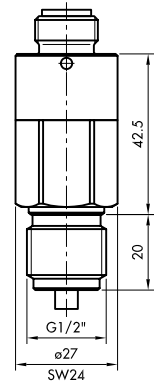

Trafag entwickelt und produziert auch speziell auf Ihre Bedürfnisse zugeschnittene Produkte. Bitte fragen Sie uns an.
Trafag développe et fabrique des produits adaptés à vos besoins spécifiques en se basant sur votre cahier des charges. Contactez-nous s.v.p.
Trafag develops and manufactures customer-engineered products according to your specifications to meet your requirements. Please contact us.