

NAIS

HIGH ELECTRICAL & MECHANICAL NOISE IMMUNITY RELAY

JQ-RELAYS

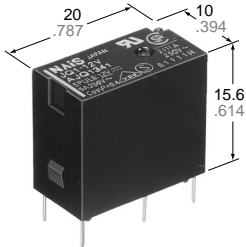

mm inch

FEATURES

- High electrical noise immunity
- High switching capacity in a compact package
- High sensitivity: 200 mW (1a), 400 mW (1c)
- High surge voltage: 8,000 V between contacts and coil
- VDE, TÜV, SEMKO also approved

SPECIFICATIONS

Contact

Standard type		High capacity type			
Arrangement 1 Form A, 1 Form C					
Initial contact resistance, max. (By voltage drop 6 V DC 1 A) 100 mΩ					
Contact material Silver alloy					
Rating (resistive)	Nominal switching capacity	1a	5 A 125 V AC 2 A 250 V AC 5 A 30 V DC	10 A 125 V AC 5 A 250 V AC 5 A 30 V DC	
		1c	N.O.	5 A 125 V AC 2 A 250 V AC 3 A 30 V AC	10 A 125 V AC 5 A 250 V AC 5 A 30 V DC
			N.C.	2 A 125 V AC 1 A 250 V AC 1 A 30 V DC	3 A 125 V AC 2 A 250 V AC 1 A 30 V DC
	Max. switching power	1a	625 VA, 150 W	1,250 VA, 150 W	
		1c	N.O.	625 VA, 90 W	1,250 V AC, 150 W
			N.C.	250 VA, 30 W	500 V AC, 30 W
Max. switching voltage		250 V AC, 110 V DC (0.3A)			
Max. switching current		N.O.: 5 A N.C.: 2 A	N.O.: 10 A N.C.: 3 A		
Expected mechanical life (at 180 cpm)(min. operations) 10 ⁷					

Expected electrical life (min. operations)

Type	Switching capacity	No. of operations		
Standard type	1a	5 A 125 V AC 5×10 ⁴		
		3 A 125 V AC 2×10 ⁵		
		2 A 250 V AC 2×10 ⁵		
	1c	5 A 30 V DC 10 ⁵		
		N.O.	5 A 125 V AC 5×10 ⁴ 2 A 250 V AC 2×10 ⁵ 3 A 30 V DC 10 ⁵	
		N.C.	2 A 125 V AC 2×10 ⁵ 1 A 250 V AC 2×10 ⁵ 1 A 30 V DC 10 ⁵	
High capacity type	1a	10 A 125 V AC 5×10 ⁴ 5 A 250 V AC 5×10 ⁴ 5 A 30 V DC 10 ⁵		
		1c	N.O.	10 A 125 V AC 5×10 ⁴ 5 A 250 V AC 5×10 ⁴ 5 A 30 V DC 10 ⁵
			N.C.	3 A 125 V AC 2×10 ⁵ 2 A 250 V AC 2×10 ⁵ 1 A 30 V DC 10 ⁵

Coil (at 20°C 68°F)

Nominal operating power	1a: 200 mW	1c: 400 mW
-------------------------	------------	------------

Characteristics

Max. operating speed		20 cpm
Initial insulation resistance*1		Min. 1,000 MΩ at 500 V DC
Initial breakdown voltage*2	Between open contacts	1a: 1,000 Vrms for 1 min. 1c: 750 Vrms for 1 min.
	Between contacts and coil	4,000 Vrms for 1 min.
Surge voltage between contact and coil*3		8,000 V
Operate time*4 (at nominal voltage)		Approx. 5 ms
Release time*4 (at nominal voltage)(without diode)		Approx. 2 ms
Temperature rise*5		Max. 45°C
Shock resistance	Functional*6	Min. 294 m/s ² {30 G}
	Destructive*7	Min. 980 m/s ² {100 G}
Vibration resistance	Functional*8	98 m/s ² {10 G}, 10 to 55 Hz at double amplitude of 1.6 mm
	Destructive	117.6 m/s ² {12 G}, 10 to 55 Hz at double amplitude of 2.0 mm
Conditions for operation, transport and storage*9 (Not freezing and condensing at low temperature)	Ambient temp.	-40°C to +70°C -40°F to +158°F
	Humidity	5 to 85% R.H.
Unit weight		Approx. 7 g .25 oz

Remarks

- * Specifications will vary with foreign standards certification ratings.
- *1 Measurement at same location as "Initial breakdown voltage" section
- *2 Detection current: 10 mA
- *3 Wave is standard shock voltage of ±1.2 × 50μs according to JEC-212-1981
- *4 Excluding contact bounce time
- *5 Measured conditions

Standard type	Resistive, nominal voltage applied to the coil. Contact carrying current: 5 A, at 70°C 158°F
High capacity type	Resistive, nominal voltage applied to the coil. Contact carrying current: 10 A, at 70°C 158°F

- *6 Half-wave pulse of sine wave: 11ms; detection time: 10μs
- *7 Half-wave pulse of sine wave: 6ms
- *8 Detection time: 10μs
- *9 Refer to 5. Conditions for operation, transport and storage mentioned in AMBIENT ENVIRONMENT (Page 61).

TYPICAL APPLICATIONS

- Air conditioners
- Refrigerators
- Microwave ovens
- Heaters

ORDERING INFORMATION

Ex. JQ 1a P — 12 V

Contact arrangement	Contact capacity	Coil voltage (DC)
1a: 1 Form A 1: 1 Form C	Nil: Standard P: High capacity	3, 5, 6, 9, 12, 18, 24, 48* V

UL/CSA, VDE, SEMKO approved type is standard.

* Available only for 1 Form C type

TYPES AND COIL DATA at 20°C 68°F

	Part No.	Nominal voltage, V DC	Pick-up voltage, V DC (min.)	Drop-out voltage, V DC (min.)	Nominal operating current, mA	Nominal operating power, mW	Coil resistance, Ω (±10%)	Max. allowable voltage, V DC
1 Form A	Standard type	JQ1a-3V	3	2.25	0.15	66.7	45	180% of nominal voltage (at 20°C 68°F)
		JQ1a-5V	5	3.75	0.25	40	125	
		JQ1a-6V	6	4.5	0.3	33.3	180	
		JQ1a-9V	9	6.75	0.45	22.2	405	
		JQ1a-12V	12	9	0.6	16.7	720	
		JQ1a-18V	18	13.5	0.9	11.1	1,620	
		JQ1a-24V	24	18	1.2	8.3	2,880	
	High capacity type	JQ1aP-3V	3	2.4	0.15	66.7	45	130% of nominal voltage (at 70°C 158°F)
		JQ1aP-5V	5	4	0.25	40	125	
		JQ1aP-6V	6	4.8	0.3	33.3	180	
		JQ1aP-9V	9	7.2	0.45	22.2	405	
		JQ1aP-12V	12	9.6	0.6	16.7	720	
		JQ1aP-18V	18	14.4	0.9	11.1	1,620	
		JQ1aP-24V	24	19.2	1.2	8.3	2,880	
1 Form C	Standard type	JQ1-3V	3	2.25	0.15	133.3	22.5	150% of nominal voltage (at 20°C 68°F)
		JQ1-5V	5	3.75	0.25	80	62.5	
		JQ1-6V	6	4.5	0.3	66.7	90	
		JQ1-9V	9	6.75	0.45	44.4	202.5	
		JQ1-12V	12	9	0.6	33.3	360	
		JQ1-18V	18	13.5	0.9	22.2	810	
		JQ1-24V	24	18	1.2	16.7	1,440	
		JQ1-48V	48	36	2.4	8.3	5,760	
	High capacity type	JQ1P-3V	3	2.4	0.15	133.3	22.5	110% of nominal voltage (at 70°C 158°F)
		JQ1P-5V	5	4	0.25	80	62.5	
		JQ1P-6V	6	4.8	0.3	66.7	90	
		JQ1P-9V	9	7.2	0.45	44.4	202.5	
		JQ1P-12V	12	9.6	0.6	33.3	360	
		JQ1P-18V	18	14.4	0.9	22.2	810	
JQ1P-24V	24	19.2	1.2	16.7	1,440			
JQ1P-48V	48	38.4	2.4	8.3	5,760			

DIMENSIONS

mm inch

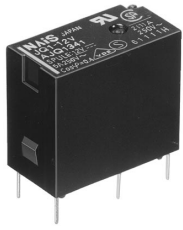

1 Form A

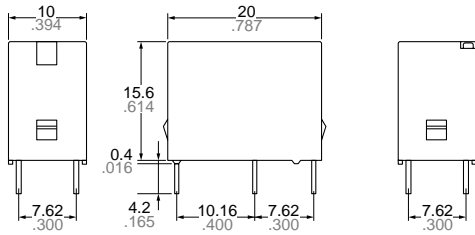

1 Form A

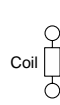

Schematic (Bottom view)

1 Form C

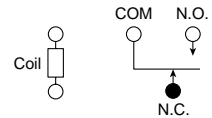

Tolerance: $\pm 0.1 \pm .004$

1 Form C

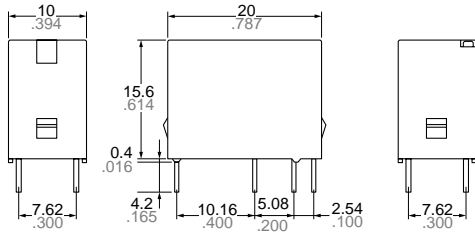

1 Form A

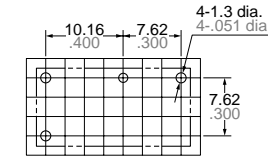

1 Form C

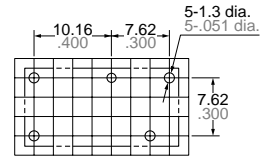

Tolerance: $\pm 0.1 \pm .004$

Dimension :

Max. 1mm	.039 inch
1 to 5mm	.039 to .118 inch
Min. 5mm	.118 inch

General tolerance

$\pm 0.2 \pm 008$
$\pm 0.3 \pm 012$
$\pm 0.4 \pm 016$

REFERENCE DATA

Standard type

1-(1). Max. switching capacity (1 Form A type)

1-(2). Max. switching capacity (1 Form C type)

2. Life curve

Ambient temperature: room temperature

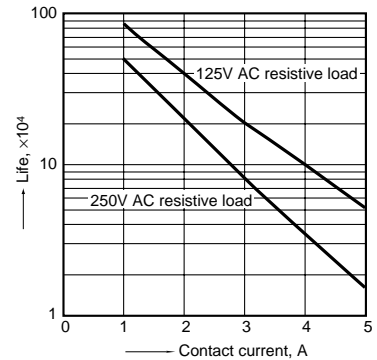
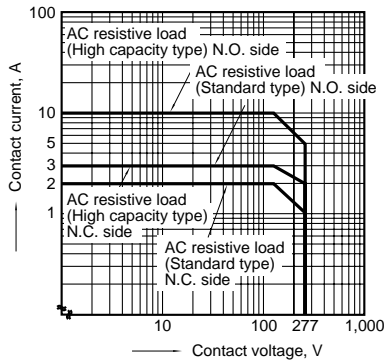
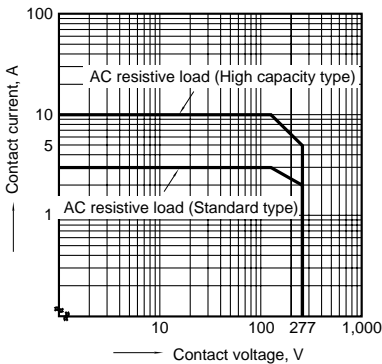

3-(1). Operate & release time (1 Form A type)

Tested sample: JQ1a-12V, 25 pcs.

3-(2). Operate & release time (1 Form C type)

Tested sample: JQ1-24V, 25 pcs.

4-(1). Coil temperature rise (1 Form A type)

Contact carrying current: 3 A, 5 A
Measured portion: Inside the coil

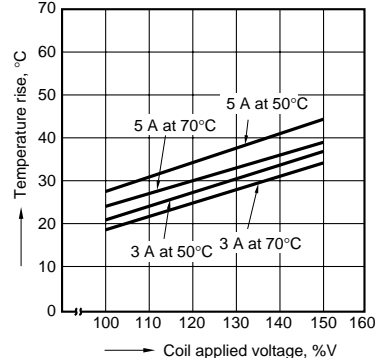
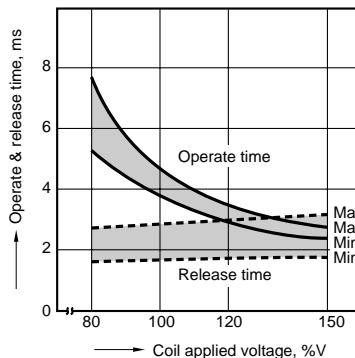
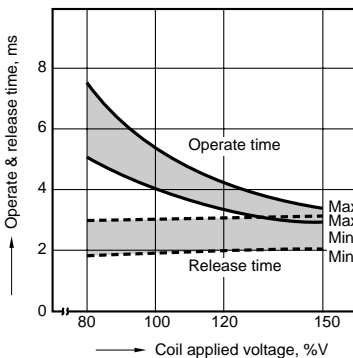

4-(2). Coil temperature rise
(1 Form C type)

Contact carrying current: 3 A, 5 A
Measured portion: Inside the coil

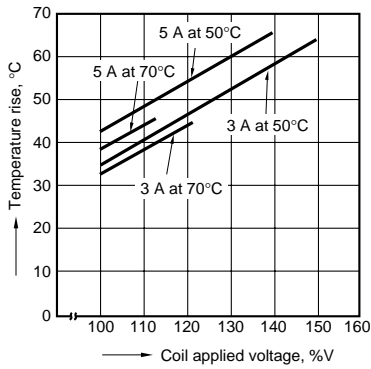

5-(1). Ambient temperature characteristics
(1 Form A type)

Tested sample: JQ1a-24V
Contact carrying current: 3 A, 5 A

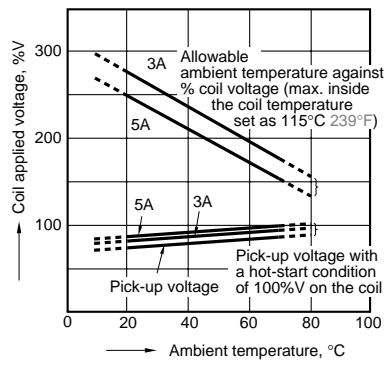

5-(2). Ambient temperature characteristics
(1 Form C type)

Tested sample: JQ1-24V
Contact carrying current: 3 A, 5 A

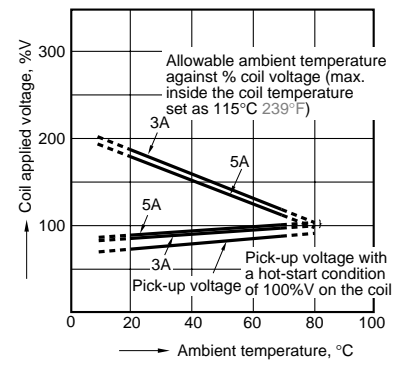

High capacity type

1-(1). Operate & release time
(1 Form A type)

Tested sample: JQ1aP-12V, 25 pcs.

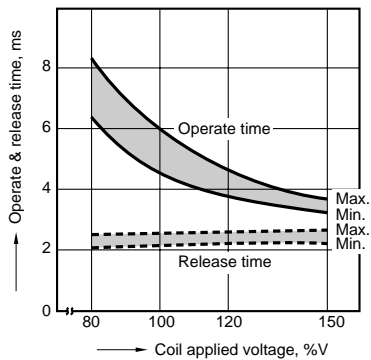

1-(2). Operate & release time
(1 Form C type)

Tested sample: JQ1P-12V, 25 pcs.

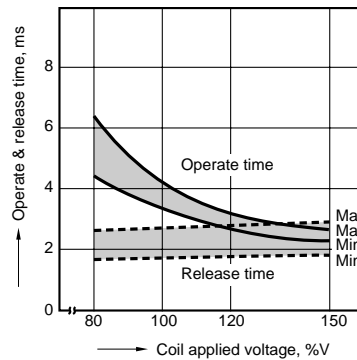

2. Life curve

Ambient temperature: room temperature

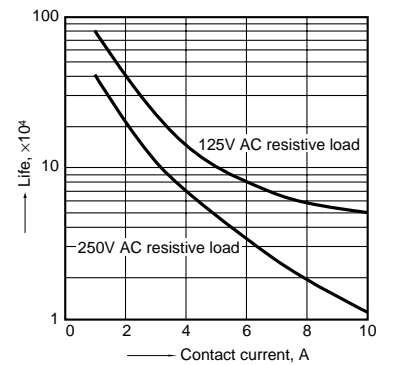

3-(1). Coil temperature rise
(1 Form A type)

Contact carrying current: 5 A, 10 A
Measured portion: Inside the coil

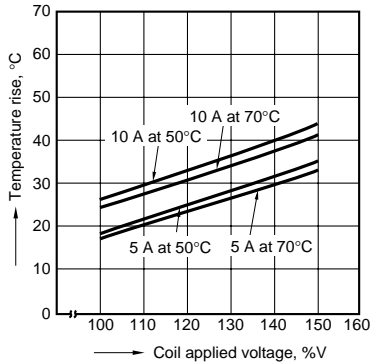

3-(2). Coil temperature rise
(1 Form C type)

Contact carrying current: 5 A, 10 A
Measured portion: Inside the coil

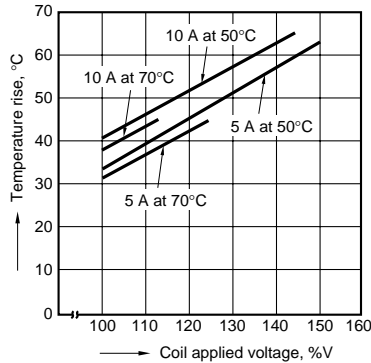

4-(1). Ambient temperature characteristics
(1 Form A type)

Tested sample: JQ1aP-24V
Contact carrying current: 5 A, 10 A

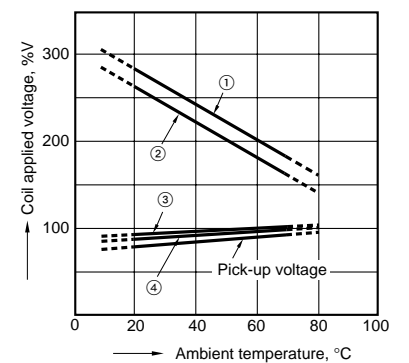

4-(2). Ambient temperature characteristics
(1 Form C type)

Tested sample: JQ1P-24V
Contact carrying current: 5 A, 10 A

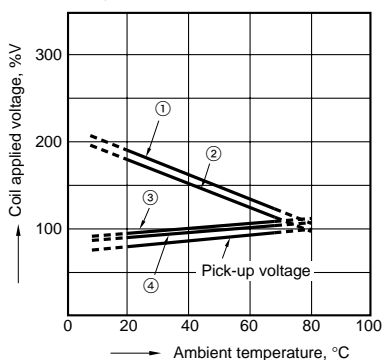

- ① Allowable ambient temperature against % coil voltage (max. inside the coil temperature set as 115°C 239°F)(Carrying current: 5 A)
- ② Allowable ambient temperature against % coil voltage (max. inside the coil temperature set as 115°C 239°F)(Carrying current: 10 A)
- ③ Pick-up voltage with a hot-start condition of 100%V on the coil (Carrying current: 10A)
- ④ Pick-up voltage with a hot-start condition of 100%V on the coil (Carrying current: 5A)

For Cautions for Use, see Relay Technical Information (Page 48 to 76).